

REGLEMENTARI URBANISTICE ZONIFICARE SC:1/1000

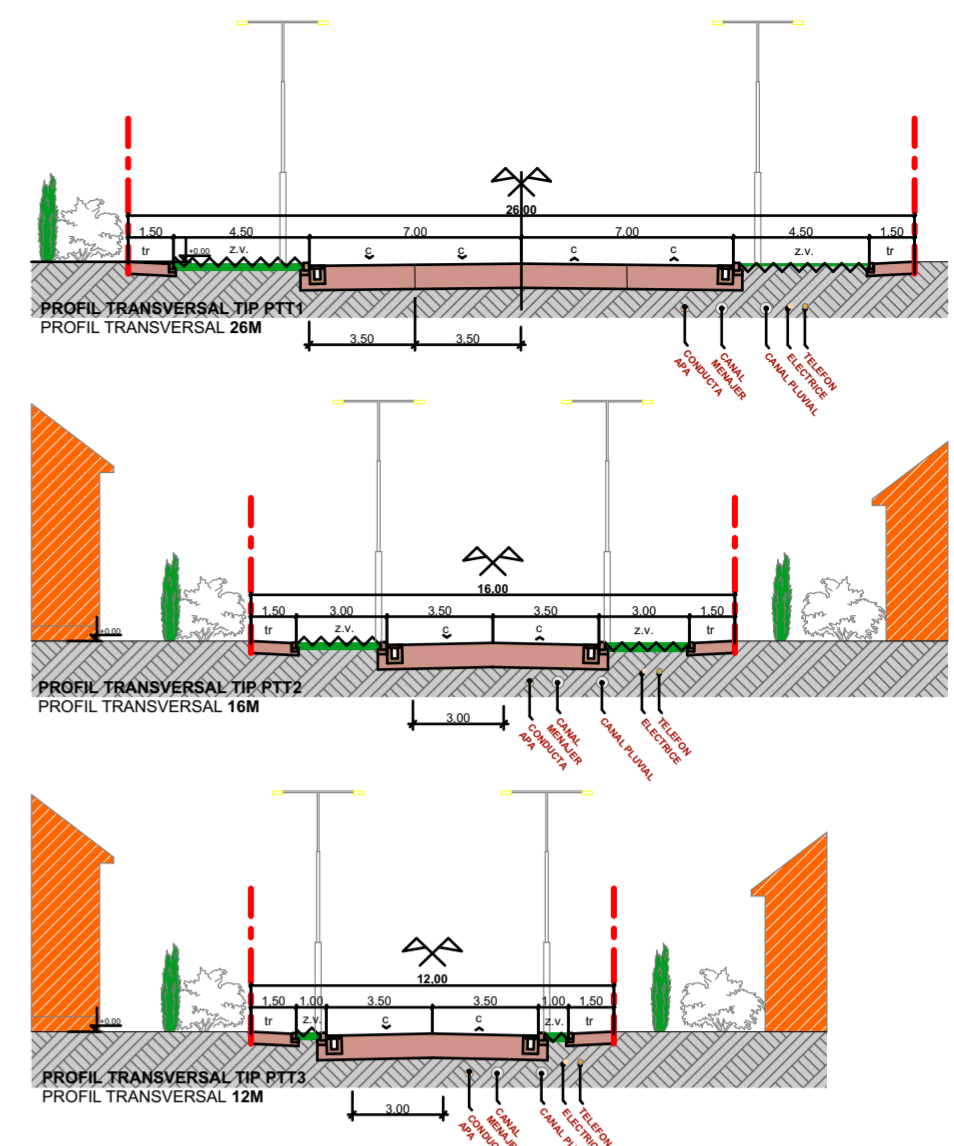
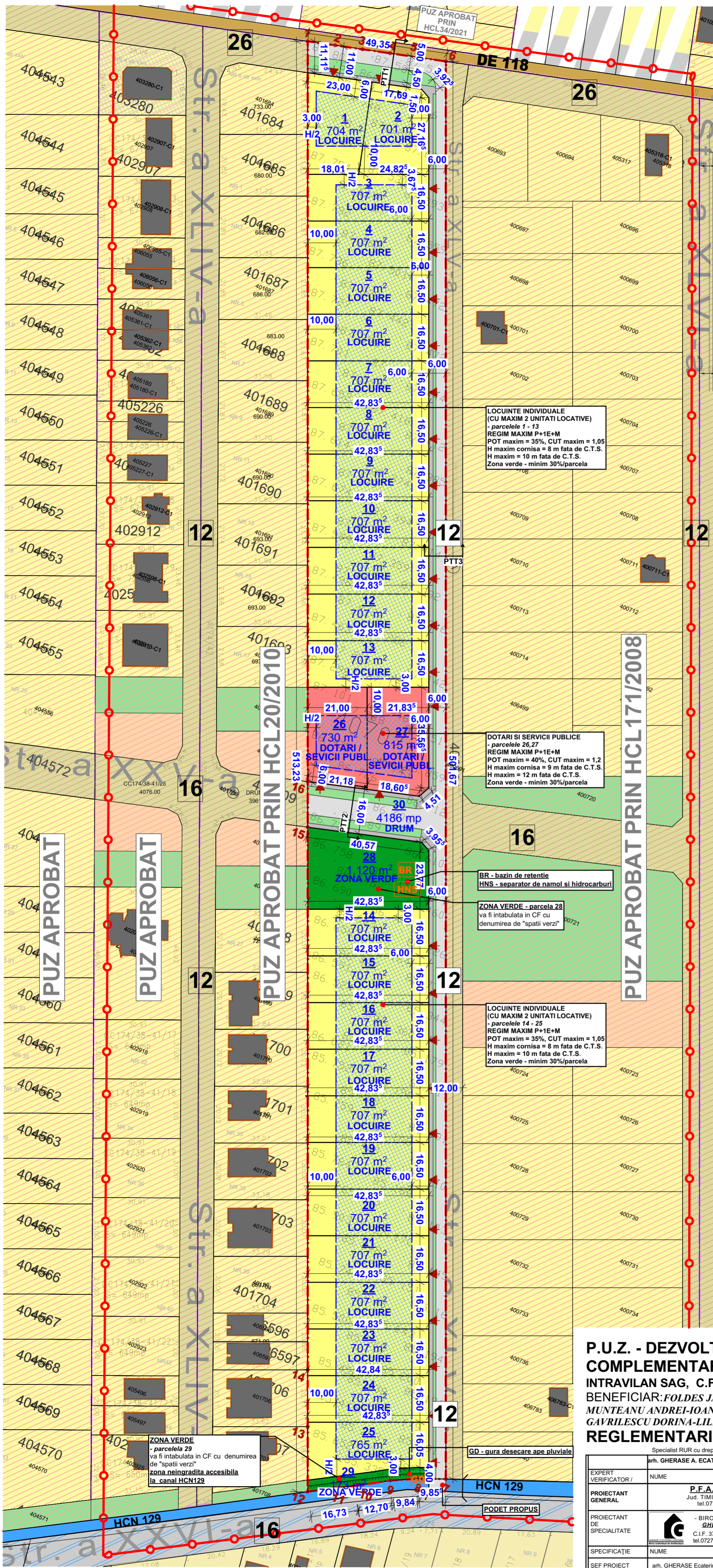

| SUPRAFATA TEREN | Propunere | | NR.PARCELA |
|--------------------------------------|----------------|-------|------------|
| | m ² | % | |
| LOCUINTE (maxim 2 unitati locative) | 17.724 | 71,61 | 1-25 |
| DRUMURI SI ACCESE | 4.186 | 16,94 | 30 |
| in care SPATII VERZI (de aliniament) | 546 | | |
| SPATII VERZI | 1293 | 5,22 | 28,29 |
| DOTARI SI SERVICII PUBLICE | 1545 | 6,23 | 26,27 |
| SUPRAFATA TOTALA TEREN | 24.748 | 100 | 30 parcele |

| | |
|----------------------------|-------------|
| SPATII VERZI | 1293 |
| SPATII VERZI de aliniament | 546 |
| TOTAL SPATII VERZI | 1839 |

| LOCUINTE INDIVIDUALE (CU MAXIM DOUA UNITATI LOCATIVE) | DOTARI SI SERVICII PUBLICE |
|---|----------------------------|
| POT max 35% | POT max 40% |
| CUT max 1,05 | CUT max 1,2 |
| Hmax cornisa 8 m Hmax 10 m | Hmax cornisa 9 m Hmax 12 m |
| P, P+M, P+1E, P+1E+M | P, P+M, P+1E, P+1E+M |

- LEGENDA P.U.Z.**
- P.U.Z.-uri aprobate
 - LIMITE**
 - LIMITA DE PROPRIETATE TEREN AFERENT PUZ
 - LIMITA ZONA STUDIATA
 - CONTUR LIMITE DE PROPRIETATE
 - ZONIFICARE PROPUSA**
 - ZONA DE LOCUINTE INDIVIDUALE (MAXIM 2 UNITATI LOCATIVE /PARCELA)
 - ZONA DOTARI SI SERVICII PUBLICE
 - ZONA DE CONSTRUIBILITATE
 - ZONA SPATII VERZI / LOC DE JOACA
 - ZONA SPATII VERZI DE ALINIAMENT
 - CANAL
 - ZONIFICARE PROPUSA IN PERSPECTIVA**
 - ZONIFICARE LOCUIRE PROPUSA
 - ZONIFICARE SERVICII/PRODUCTIE PROPUSA
 - ZONIFICARE ZONA VERDE PROPUSA
 - ZONA DRUMURI PROPUSA
 - CAI DE COMUNICATIE**
 - DRUMURI EXISTENTE
 - DRUMURI PROPUSA
 - ZONE DE PROTECTIE**
 - ZONA PROTECTIE CANAL 2M
 - CONSTRUCTII**
 - CONSTRUCTIE EXISTENTA
 - DRUMURI**
 - DRUM DE PAMANT
 - DRUM EXISTENT
 - PODEȚ PROPUS

PARCELA CF 407072

| Nr. Pct. | Coordonate pct.de contur | |
|----------|--------------------------|------------|
| | X [m] | Y [m] |
| 1 | 468634.315 | 202873.536 |
| 2 | 468636.324 | 202883.098 |
| 3 | 468638.344 | 202892.711 |
| 4 | 468640.375 | 202902.377 |
| 5 | 468642.415 | 202912.086 |
| 6 | 468644.460 | 202921.830 |
| 7 | 468173.460 | 203094.550 |
| 8 | 468170.179 | 203085.259 |
| 9 | 468166.219 | 203076.257 |
| 10 | 468161.479 | 203067.582 |
| 11 | 468157.021 | 203058.863 |
| 12 | 468152.460 | 203050.233 |
| 13 | 468147.072 | 203042.308 |
| 14 | 468142.953 | 203035.384 |
| 15 | 468137.212 | 202969.283 |
| 16 | 468386.363 | 202963.727 |

S=24748mp

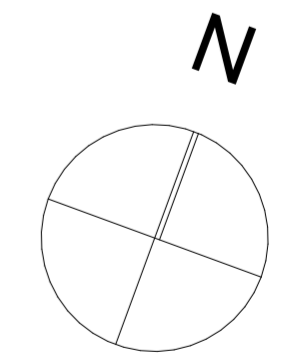

P.U.Z. - DEZVOLTARE ZONA RESIDENTIALA SI FUNCTIUNI COMPLEMENTARE, DOTARI SI SERVICII PUBLICE
INTRAVILAN SAG, C.F.407072, S = 24.748 mp
 BENEFICIAR: FOLDES JANOS, RADU DAN-CRISTIAN, VISOIU HOREA-NICOLAE, VISOIU MIHAELA, MUNTEANU ANDREI-IOAN, MUNTEANU CRISTINA-MARIA, CARAGIA VASILE, GAVRILESCU IOAN, GAVRILESCU DORINA-LILIANA, LITRA AUREL-FLORIN, LITRA VALENTINA
REGLEMENTARI URBANISTICE SC.1:1000

| EXPERT VERIFICATOR / | NUME | SEMNTURA | CERINȚA | REFERAT / EXPERTIZĂ NR. / DATA |
|----------------------------|--|----------|-----------------|--|
| PROIECTANT GENERAL | P.F.A. Pușcău Astrid Patricia Dana Jud. Timiș, SAG, Str. I, Nr. 59, cod fiscal 31464957 tel.0723199755, astrid_puscau@yahoo.com | | | Beneficiar / FOLDES JANOS, RADU DAN-CRISTIAN, VISOIU HOREA-NICOLAE, VISOIU MIHAELA, MUNTEANU ANDREI-IOAN, MUNTEANU CRISTINA-MARIA, CARAGIA VASILE, GAVRILESCU IOAN, GAVRILESCU DORINA-LILIANA, LITRA AUREL-FLORIN, LITRA VALENTINA |
| PROIECTANT DE SPECIALITATE | - BIROU INDIVIDUAL DE ARHITECTURA - GHERASE ECATERINA LOREDANA C.I.F. 37122422, Sanmihaiu Roman, nr.529A, Jud.Timis, tel.0727848355, loredeagherase@gmail.com | | | Adresa simulării: CF 407072, Intravilan Sag, Jud.Timis |
| ȘEF PROIECT | arh. GHERASE Ecaterina Loredana | | Scara: 1:1000 | Titlul proiectului: P.U.Z. - DEZVOLTARE ZONA RESIDENTIALA SI FUNCTIUNI COMPLEMENTARE, DOTARI SI SERVICII PUBLICE |
| PROIECT | arh. GHERASE Ecaterina Loredana | | Data: oct. 2023 | Titlul planșii: REGLEMENTARI URBANISTICE ZONIFICARE |
| DESENAT | arh. GHERASE Ecaterina Loredana | | | Faza P.U.Z. Planșa nr. 02 |